

Concrete Pool Inlets

Description:

Adjustable floor inlet with swivel joint body in PVC. Regulating screw in POM. Max. Flow rate: 14m³/h. To be fixed on 65 mm diameter pipe and wall conduit 23665.

Model	Product Code
Adjustable floor inlet - swivel joint	22353

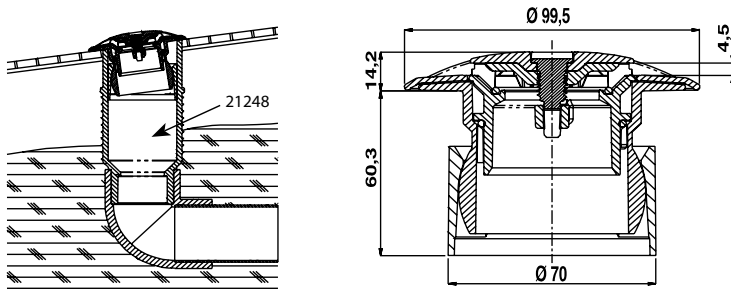

S standard Packaging	S standard Weight kg	S standard Volume m ³
24	4.1	0.022

Swivel body in PVC. Lid in ABS. Regulating screw in POM. Max. flow rate: 9.5 m³/h.

To be fixed on Ø 75 mm pipe and wall conduit 21248.

Pool Inlets



Return inlet multiflow (2" male thread) - Concrete

Code	Standard Packaging	Standard Weight kg	Standard Volume m ³
00295	24	4.35	0.020

2" male thread, inner Ø 50 mm for glueing. Made in white ABS. Can be installed with wall conduits: 15658-15659.

Floor Return Inlet 2" Thread - Vinyl or Concrete

Code	Standard Packaging	Standard Weight kg	Standard Volume m ³
00340	12	5.4	0.020

For water return. With gaskets, flanges and screws. Adjustable flow. Max. flow rate: 12 m³/h

Wall Return Inlet - Fibreglass - 90mm For panel pools

Wall Return Inlet - Skypool - 90mm For prefabricated pools

Code	Standard Packaging	Standard Weight kg	Standard Volume m ³
41518	10	5.50	0.021
41521	12	4.20	0.021

Inlet nozzles for large flows and they can be used as suction nozzle also. Inlet flow rate 30m³/h for a maximum water flow velocity of 4m/s according to EN 13451-1 standard. Suction flow rate 5m³/h for a maximum water flow velocity of 0.5 m/s according to EN 13451-1 standard. PVC body. Ø75 or Ø90 pipe connection. The nozzle can be installed in the wall conduit 43590. 3 models available for Concrete pools, prefabricated pools and panel pools. Grilles can be oriented in any direction.

Concrete Wall Return Inlet - 90mm

Inlet/suction nozzle for large flows and Concrete pools

Code	Standard Packaging	Standard Weight kg	Standard Volume m ³
41520	16	4.20	0.021

Inlet nozzles for large flows and they can be also be used as suction nozzle. Inlet flow rate 30m³/h for a maximum water flow velocity of 4m/s according to EN 13451-1 standard. Suction flow rate 5m³/h for a maximum water flow velocity of 0.5m/s according to EN 13451-1 standard. PVC body, ABS grille, PA flange and AISI 304 screws, holes in grilles are not bigger than 8mm according to EN 13451-1 standard. Ø75 or Ø90 pipe connection. The nozzle can be installed into the wall conduit 43590. 3 models available for Concrete pools and panel pools.

Reducing Conduit

Description:

Reducing conduit 50mm OD x 65mm ID

Model	Product Code
Reducing cond 50mm OD x 65mm ID	23665



Rainbow Pool Products

PO Box 2388, Mansfield Qld 4122

Telephone STD 61-7-3849 5385

Facsimile STD 61-7-3849 5384

Email: info@rainbowpoolproducts.com.au

Web: www.rainbowpoolproducts.com.au